

☑ Super Passive House

($U_{wall}=0.10 \text{ W/m}^2\text{K}$, $U_{roof}=0.08 \text{ W/m}^2\text{K}$)

1022.6 ft²

(Gross Internal Area)

Baltica Series

drawing not to scale

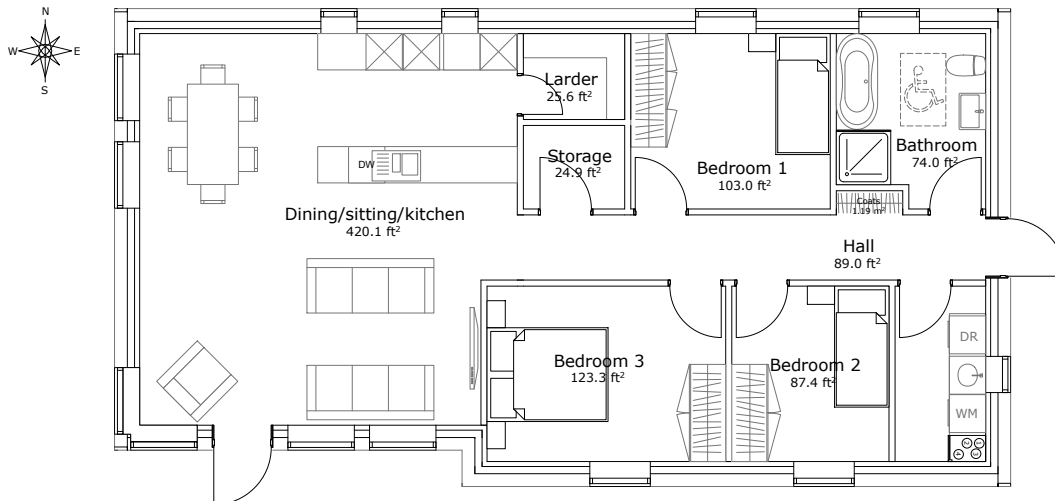

Internal dimensions: 24.0 ft x 46.6 ft

External dimensions: 25.9 ft x 48.6 ft

This modern design with its 35° roof pitch has no attic conversion but contains all spaces expected in a modern home on one level. The large glazing in the living room is set back into the building to allow shading in summer to protect the living areas from becoming too warm. The wall cladding in the set back area is vertical, stained pine boards.

The design allows for 3 bedrooms.

